

2021-200

August 10, 2021

VIA EMAIL & MAIL

Mr. David Harris, Supervisor
Town of Schodack
265 Schuurman Road
Castleton, New York 12033

Re: **SEQRA Review**
Replacement Bridges over Moordener Kill
Town of Schodack, New York

Dear Mr. Harris:

Please be informed that our office is preparing permit application documents for both the temporary bridge crossing and an eventual permanent replacement bridge crossing to the Town's well site parcel. In furtherance of that application, we are enclosing materials for your project review under the State Environmental Quality Review Act (SEQRA).

We propose that this is an "Unlisted Action" pursuant to NYCRR 6 Section 617.5 (c)(2) replacing a structure on the same site and (c)(42) emergency action to protect property. As such, a coordinated review among agencies is optional and which we recommend to forego.

Enclosed please find a short Environmental Assessment Form (SEAF) and a project location map (the sketch prepared by William J. Keller, Inc.).

We ask that the Town Board review and act on this form and materials as soon as is convenient. A short resolution indicating that the Board has reviewed the SEAF, finds no impact, and therefore issues a Negative Declaration for this action.

If you have any questions or concerns regarding this information, please contact us immediately.

Very truly yours,
LABERGE GROUP

By:

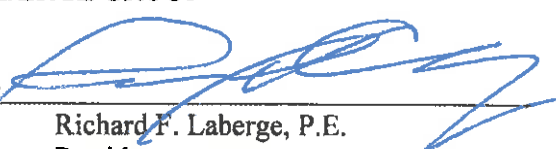
Richard F. Laberge, P.E.
President

JAK/RFL: jkb
Enc.

C. Dawne Kelly, Assistant to the Supervisor, w/enc. (via email only)
Ken Holmes, Highway Superintendent, w/enc. (via email only)

J:\2021094\CORRESPONDENCE\SEQRA\SCHODACK - SEAF 08-10-2021.DOCX

Short Environmental Assessment Form

Part 1 - Project Information

Instructions for Completing

Part 1 – Project Information. The applicant or project sponsor is responsible for the completion of Part 1. Responses become part of the application for approval or funding, are subject to public review, and may be subject to further verification. Complete Part 1 based on information currently available. If additional research or investigation would be needed to fully respond to any item, please answer as thoroughly as possible based on current information.

Complete all items in Part 1. You may also provide any additional information which you believe will be needed by or useful to the lead agency; attach additional pages as necessary to supplement any item.

Part 1 – Project and Sponsor Information			
Name of Action or Project: Replacement Bridges at Moordener Kill			
Project Location (describe, and attach a location map): Town Hall Lane bridge, 230±l.f. north of the intersection with NY Route 150, and a point 220±l.f. east of the first, both locations crossing Moordener Kill.			
Brief Description of Proposed Action: It is proposed to replace a bridge span that was washed out on or about Wednesday July 14, 2021. Prior to full design and permitting, it is proposed to install a temporary bridge span 220± l.f. upstream, which will be removed after the permanent replacement span is completed and in service. This review action will cover both phases of the project.			
Name of Applicant or Sponsor: Kenneth J. Holmes, Supt. of Highways, Town of Schodack		Telephone: (518) 766-4000 E-Mail: ken.holmes@schodack.org	
Address: 3776 U.S. Route 20			
City/PO: Nassau		State: NY	Zip Code: 12123
1. Does the proposed action only involve the legislative adoption of a plan, local law, ordinance, administrative rule, or regulation? If Yes, attach a narrative description of the intent of the proposed action and the environmental resources that may be affected in the municipality and proceed to Part 2. If no, continue to question 2.			NO <input type="checkbox"/>
			YES <input type="checkbox"/>
2. Does the proposed action require a permit, approval or funding from any other government Agency? If Yes, list agency(s) name and permit or approval: NYSDEC (Article 15) and U.S. ACOE (U.S. Clean Waters Act)			NO <input type="checkbox"/>
			YES <input checked="" type="checkbox"/>
3. a. Total acreage of the site of the proposed action?		2.0± acres	
b. Total acreage to be physically disturbed?		0.5± acres	
c. Total acreage (project site and any contiguous properties) owned or controlled by the applicant or project sponsor?		11.5± acres	
4. Check all land uses that occur on, are adjoining or near the proposed action:			
5. <input type="checkbox"/> Urban <input checked="" type="checkbox"/> Rural (non-agriculture) <input type="checkbox"/> Industrial <input checked="" type="checkbox"/> Commercial <input checked="" type="checkbox"/> Residential (suburban)			
<input checked="" type="checkbox"/> Forest <input type="checkbox"/> Agriculture <input type="checkbox"/> Aquatic <input checked="" type="checkbox"/> Other(Specify): Municipal utilities, Municipal DPW storage			
<input type="checkbox"/> Parkland			

5. Is the proposed action,	NO	YES	N/A
a. A permitted use under the zoning regulations?	<input type="checkbox"/>	<input type="checkbox"/>	<input checked="" type="checkbox"/>
b. Consistent with the adopted comprehensive plan?	<input type="checkbox"/>	<input type="checkbox"/>	<input checked="" type="checkbox"/>
6. Is the proposed action consistent with the predominant character of the existing built or natural landscape?	NO	YES	
	<input type="checkbox"/>	<input checked="" type="checkbox"/>	
7. Is the site of the proposed action located in, or does it adjoin, a state listed Critical Environmental Area? If Yes, identify: _____	NO	YES	
	<input checked="" type="checkbox"/>	<input type="checkbox"/>	
8. a. Will the proposed action result in a substantial increase in traffic above present levels? b. Are public transportation services available at or near the site of the proposed action? c. Are any pedestrian accommodations or bicycle routes available on or near the site of the proposed action?	NO	YES	
	<input checked="" type="checkbox"/>	<input type="checkbox"/>	
	<input type="checkbox"/>	<input checked="" type="checkbox"/>	
	<input checked="" type="checkbox"/>	<input type="checkbox"/>	
9. Does the proposed action meet or exceed the state energy code requirements? If the proposed action will exceed requirements, describe design features and technologies: _____ _____	NO	YES	
	<input checked="" type="checkbox"/>	<input type="checkbox"/>	
10. Will the proposed action connect to an existing public/private water supply? If No, describe method for providing potable water: _____ _____	NO	YES	
	<input checked="" type="checkbox"/>	<input type="checkbox"/>	
11. Will the proposed action connect to existing wastewater utilities? If No, describe method for providing wastewater treatment: _____ _____	NO	YES	
	<input checked="" type="checkbox"/>	<input type="checkbox"/>	
12. a. Does the project site contain, or is it substantially contiguous to, a building, archaeological site, or district which is listed on the National or State Register of Historic Places, or that has been determined by the Commissioner of the NYS Office of Parks, Recreation and Historic Preservation to be eligible for listing on the State Register of Historic Places? b. Is the project site, or any portion of it, located in or adjacent to an area designated as sensitive for archaeological sites on the NY State Historic Preservation Office (SHPO) archaeological site inventory?	NO	YES	
	<input checked="" type="checkbox"/>	<input type="checkbox"/>	
	<input type="checkbox"/>	<input checked="" type="checkbox"/>	
13. a. Does any portion of the site of the proposed action, or lands adjoining the proposed action, contain wetlands or other waterbodies regulated by a federal, state or local agency? b. Would the proposed action physically alter, or encroach into, any existing wetland or waterbody? If Yes, identify the wetland or waterbody and extent of alterations in square feet or acres: _____ Moordener Kill, 4,250± s.f. (0.097± ac)for bank stabilization armor. Moordener Kill floodplain, 3,600± s.f. (0.083± s.f.) _____ _____	NO	YES	
	<input type="checkbox"/>	<input checked="" type="checkbox"/>	
	<input type="checkbox"/>	<input checked="" type="checkbox"/>	

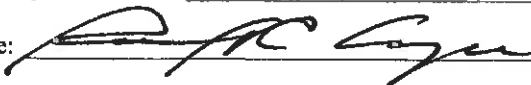
14. Identify the typical habitat types that occur on, or are likely to be found on the project site. Check all that apply:		
<input checked="" type="checkbox"/> Shoreline <input checked="" type="checkbox"/> Forest <input checked="" type="checkbox"/> Agricultural/grasslands <input type="checkbox"/> Early mid-successional <input type="checkbox"/> Wetland <input type="checkbox"/> Urban <input type="checkbox"/> Suburban		
15. Does the site of the proposed action contain any species of animal, or associated habitats, listed by the State or Federal government as threatened or endangered?	NO	YES
	<input checked="" type="checkbox"/>	<input type="checkbox"/>
16. Is the project site located in the 100-year flood plan?	NO	YES
	<input type="checkbox"/>	<input checked="" type="checkbox"/>
17. Will the proposed action create storm water discharge, either from point or non-point sources?	NO	YES
If Yes,	<input type="checkbox"/>	<input checked="" type="checkbox"/>
a. Will storm water discharges flow to adjacent properties?	<input checked="" type="checkbox"/>	<input type="checkbox"/>
b. Will storm water discharges be directed to established conveyance systems (runoff and storm drains)?	<input checked="" type="checkbox"/>	<input type="checkbox"/>
If Yes, briefly describe:		
Temporary. Sheet flow from new gravel drive on bridge approaches, which will be later removed.		
18. Does the proposed action include construction or other activities that would result in the impoundment of water or other liquids (e.g., retention pond, waste lagoon, dam)?	NO	YES
If Yes, explain the purpose and size of the impoundment:	<input checked="" type="checkbox"/>	<input type="checkbox"/>
19. Has the site of the proposed action or an adjoining property been the location of an active or closed solid waste management facility?	NO	YES
If Yes, describe:	<input checked="" type="checkbox"/>	<input type="checkbox"/>
20. Has the site of the proposed action or an adjoining property been the subject of remediation (ongoing or completed) for hazardous waste?	NO	YES
If Yes, describe:	<input checked="" type="checkbox"/>	<input type="checkbox"/>
I CERTIFY THAT THE INFORMATION PROVIDED ABOVE IS TRUE AND ACCURATE TO THE BEST OF MY KNOWLEDGE		
Applicant/sponsor/name: <u>Town of Schodack</u> Date: <u>August 11, 2021</u>		
Signature:  Title: <u>Engineering Consultant</u>		



Disclaimer: The EAF Mapper is a screening tool intended to assist project sponsors and reviewing agencies in preparing an environmental assessment form (EAF). Not all questions asked in the EAF are answered by the EAF Mapper. Additional information on any EAF question can be obtained by consulting the EAF Workbooks. Although the EAF Mapper provides the most up-to-date digital data available to DEC, you may also need to contact local or other data sources in order to obtain data not provided by the Mapper. Digital data is not a substitute for agency determinations.



Part 1 / Question 7 [Critical Environmental Area]	No
Part 1 / Question 12a [National or State Register of Historic Places or State Eligible Sites]	No
Part 1 / Question 12b [Archeological Sites]	Yes
Part 1 / Question 13a [Wetlands or Other Regulated Waterbodies]	Yes - Digital mapping information on local and federal wetlands and waterbodies is known to be incomplete. Refer to EAF Workbook.
Part 1 / Question 15 [Threatened or Endangered Animal]	No
Part 1 / Question 16 [100 Year Flood Plain]	Digital mapping data are not available or are incomplete. Refer to EAF Workbook.
Part 1 / Question 20 [Remediation Site]	No

Project: Date:

Short Environmental Assessment Form
Part 2 - Impact Assessment

Part 2 is to be completed by the Lead Agency.

Answer all of the following questions in Part 2 using the information contained in Part 1 and other materials submitted by the project sponsor or otherwise available to the reviewer. When answering the questions the reviewer should be guided by the concept "Have my responses been reasonable considering the scale and context of the proposed action?"

	No, or small impact may occur	Moderate to large impact may occur
1. Will the proposed action create a material conflict with an adopted land use plan or zoning regulations?	<input checked="" type="checkbox"/>	<input type="checkbox"/>
2. Will the proposed action result in a change in the use or intensity of use of land?	<input checked="" type="checkbox"/>	<input type="checkbox"/>
3. Will the proposed action impair the character or quality of the existing community?	<input checked="" type="checkbox"/>	<input type="checkbox"/>
4. Will the proposed action have an impact on the environmental characteristics that caused the establishment of a Critical Environmental Area (CEA)?	<input checked="" type="checkbox"/>	<input type="checkbox"/>
5. Will the proposed action result in an adverse change in the existing level of traffic or affect existing infrastructure for mass transit, biking or walkway?	<input checked="" type="checkbox"/>	<input type="checkbox"/>
6. Will the proposed action cause an increase in the use of energy and it fails to incorporate reasonably available energy conservation or renewable energy opportunities?	<input checked="" type="checkbox"/>	<input type="checkbox"/>
7. Will the proposed action impact existing:		
a. public / private water supplies?	<input checked="" type="checkbox"/>	<input type="checkbox"/>
b. public / private wastewater treatment utilities?	<input checked="" type="checkbox"/>	<input type="checkbox"/>
8. Will the proposed action impair the character or quality of important historic, archaeological, architectural or aesthetic resources?	<input checked="" type="checkbox"/>	<input type="checkbox"/>
9. Will the proposed action result in an adverse change to natural resources (e.g., wetlands, waterbodies, groundwater, air quality, flora and fauna)?	<input checked="" type="checkbox"/>	<input type="checkbox"/>
10. Will the proposed action result in an increase in the potential for erosion, flooding or drainage problems?	<input checked="" type="checkbox"/>	<input type="checkbox"/>
11. Will the proposed action create a hazard to environmental resources or human health?	<input checked="" type="checkbox"/>	<input type="checkbox"/>

Project: _____

Date: _____

Short Environmental Assessment Form Part 3 Determination of Significance

For every question in Part 2 that was answered "moderate to large impact may occur", or if there is a need to explain why a particular element of the proposed action may or will not result in a significant adverse environmental impact, please complete Part 3. Part 3 should, in sufficient detail, identify the impact, including any measures or design elements that have been included by the project sponsor to avoid or reduce impacts. Part 3 should also explain how the lead agency determined that the impact may or will not be significant. Each potential impact should be assessed considering its setting, probability of occurring, duration, irreversibility, geographic scope and magnitude. Also consider the potential for short-term, long-term and cumulative impacts.

NA

<input type="checkbox"/> Check this box if you have determined, based on the information and analysis above, and any supporting documentation, that the proposed action may result in one or more potentially large or significant adverse impacts and an environmental impact statement is required.	
<input checked="" type="checkbox"/> Check this box if you have determined, based on the information and analysis above, and any supporting documentation, that the proposed action will not result in any significant adverse environmental impacts.	
Town of Schodack Town Board <hr/> Name of Lead Agency	August 12th, 2021 <hr/> Date
David Harris <hr/> Print or Type Name of Responsible Officer in Lead Agency	Supervisor <hr/> Title of Responsible Officer
_____ Signature of Responsible Officer in Lead Agency	_____ Signature of Preparer (if different from Responsible Officer)

PRINT FORM

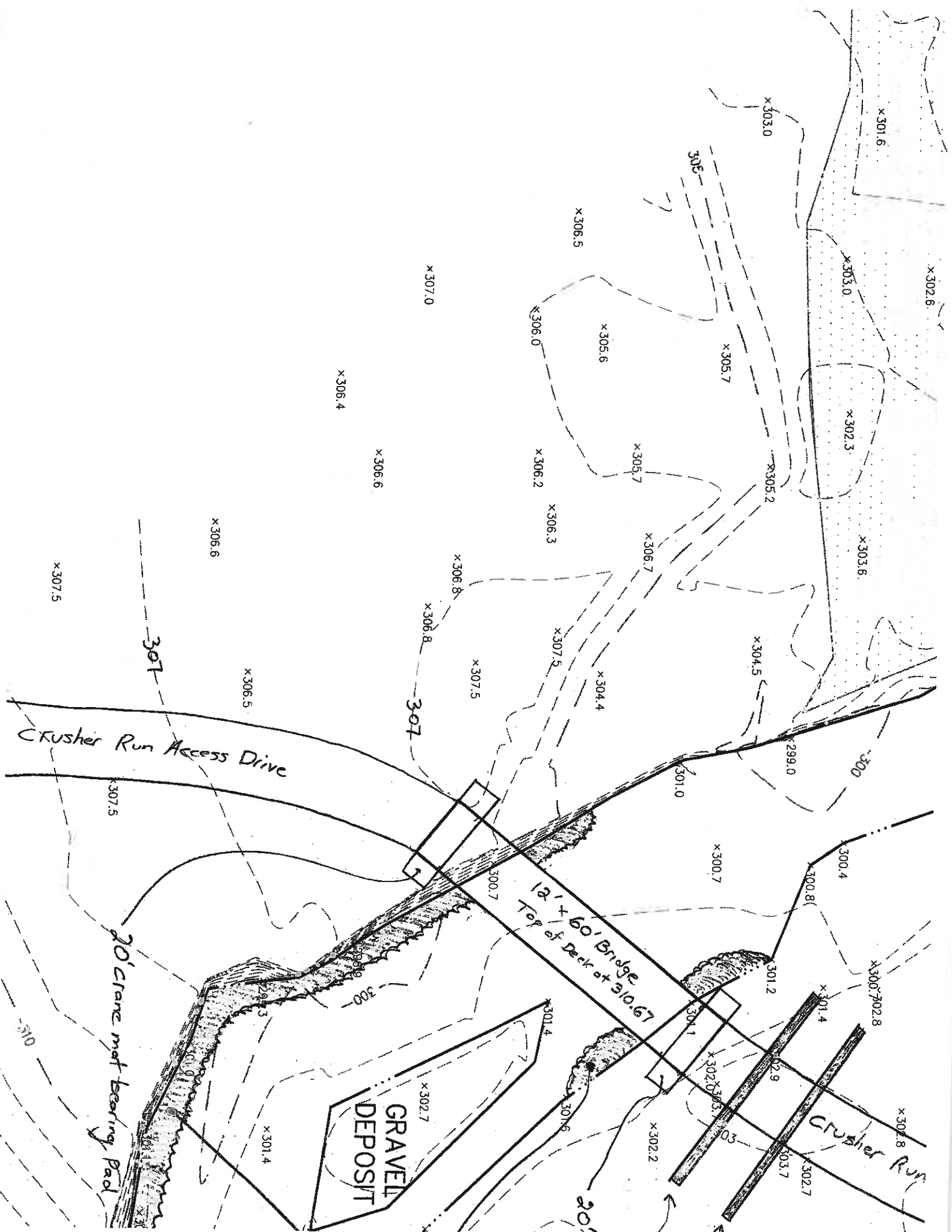

Crusher Run Access Drive

30' crane mat bearing pad

12' x 60' Bridge
Top of Deck at 310.67

GRAVEL
DEPOSIT

Crusher Run

x307.5

x306.6

x306.4

x306.6

x307.0

x306.5

x306.0

x305.6

x305.7

x305.7

x306.2

x306.3

x305.7

x306.7

x306.8

x306.8

x307.5

x307.5

x304.4

x304.5

299.0

307

307

x306.5

x307.5

301.0

x300.7

300.4

x300.81

x300.7

301.2

x301.4

x300.702.8

x30.8

x301.4

x302.0

x302.0

x302.2

302.9

x302.7

x302.7

301.6

301

x301.6

x303.0

x303.0

x302.3

x303.6

x302.6

300

310

300

300

300